



OrbiCHECK Validation Sensor Assembly

The OrbiCHECK validation sensor is available in both Industrial and Sanitary designs. The OrbiCHECK validates the rotation of tank cleaning devices by monitoring the rotation of the cleaning jet.

The OrbiCHECK is designed to validation rotation for Rotating Jet-Head cleaning devices. The OrbiCHECK is typically mounted on the installation flange for the tank cleaning device or other stationary installation mechanism that will maintain a constant geometry with relation to impact locations of the cleaning jet and the OrbiCHECK sensor. A four digit LED display in units of BAR, MPa, and PSI are displayed to measure sensor impact values.

The OrbiCHECK comes complete with pressure sensor, power supply/switching amplifier, weld adapter, and cable harness 10 meters in length. An optional TriClamp weld adapter is also available for sanitary connections.

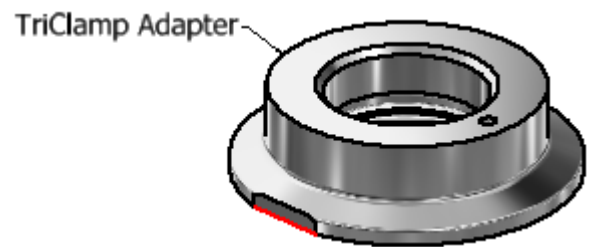
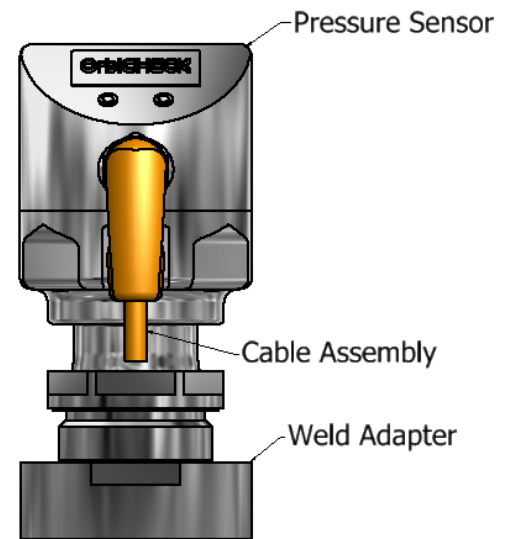
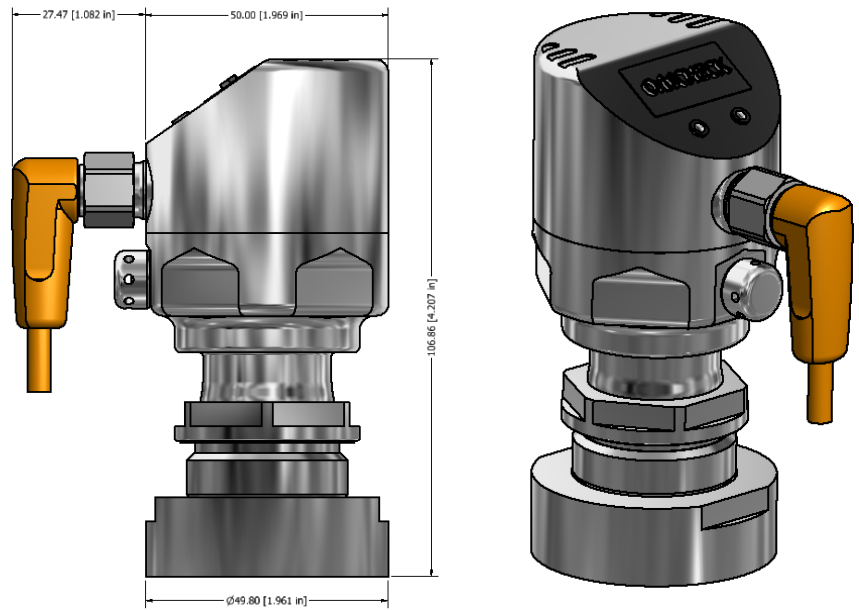

OrbiCHECK components are...

Part Number	Qty Required	Description
PI2794	1	Pressure sensor
DN0012	1	Power supply/switching amplifier
EVT005	1	Cable harness; 10 meters
E33130	1	Weld adapter; industrial
E33209	1	Weld adapter; sanitary
02PN.1829.00	1	Assembly part number that includes PI2794, DN0012, EVT005, and E30130
Contact Orbijet Engineering for any additional details required on these components. Email: eng@orbijet.com or website: www.orbijet.com		

Connector is a type BNC 5 point connector with wiring schematic as in figure 1 below.

Core colors
 BK black
 BN brown
 BU blue
 WH white

